

# AutoCAD 2D

## Drawing Exercise – Drawing a Site Layout

This exercise is designed to help you understand how to construct drawings from given dimensions and how to use the various drawing and modify tools and the drawing aids to create new drawing elements and to assemble them accurately.

The illustration below shows the boundary of a development site and two office buildings. All dimensions are in metres. Use the dimensions and co-ordinates to accurately draw the site boundary and building footprints (you do not need to draw the dimensions, these are for information only).

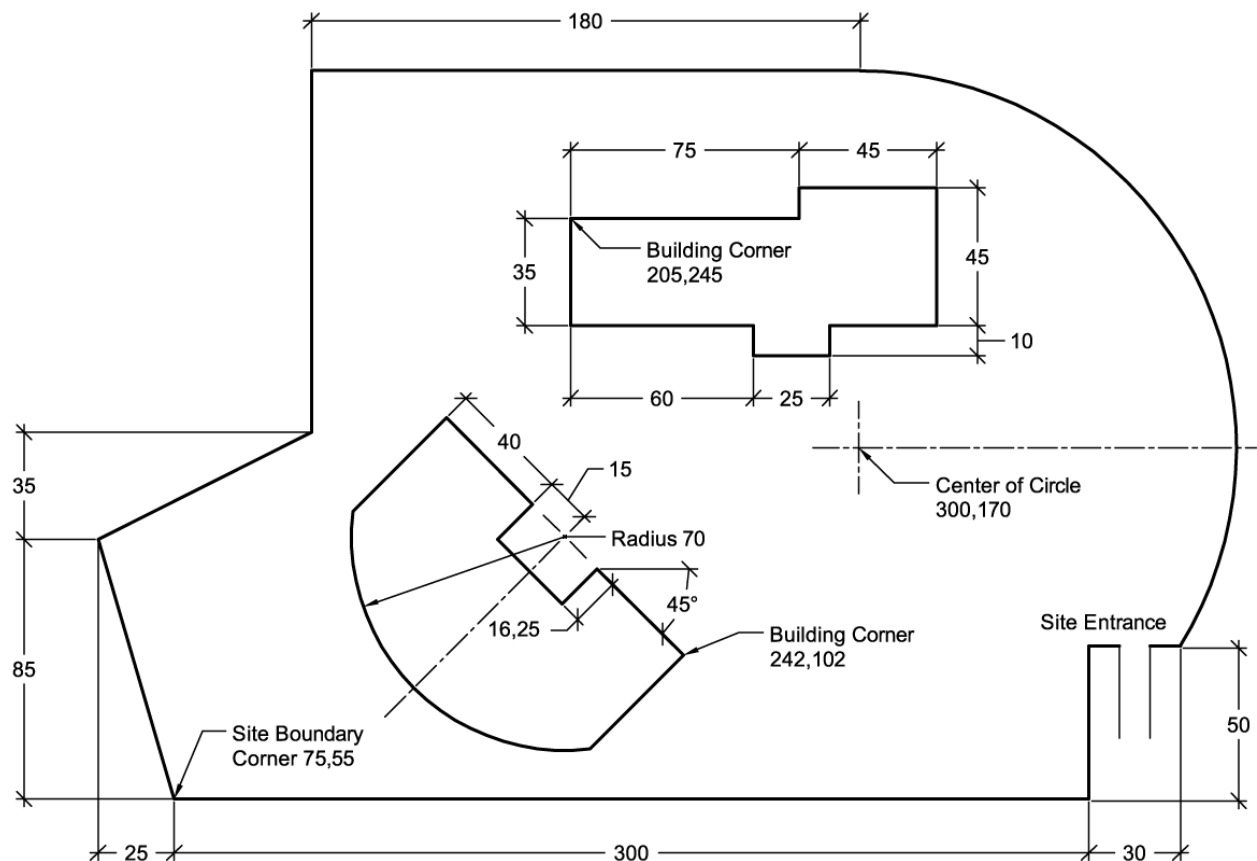

### Tips

There are an infinite number of ways to construct this drawing; there isn't a right way or a wrong way. Use the drawing and modify skills you have learned earlier today to construct the drawing in the most logical way. If you're not sure how to proceed, consider how you would construct the drawing on a drawing board.

There are lots of tools that can help you complete this drawing quickly and easily. Consider using Direct Distance Entry and Polar Snap or even Object Snap Tracking.

If you get stuck, ask for help!